

UNIVERSITY OF SOUTH CAROLINA HUMANITIES OFFICE AND CLASSROOM BUILDINGS REROOFING CONSTRUCTION PROJECT

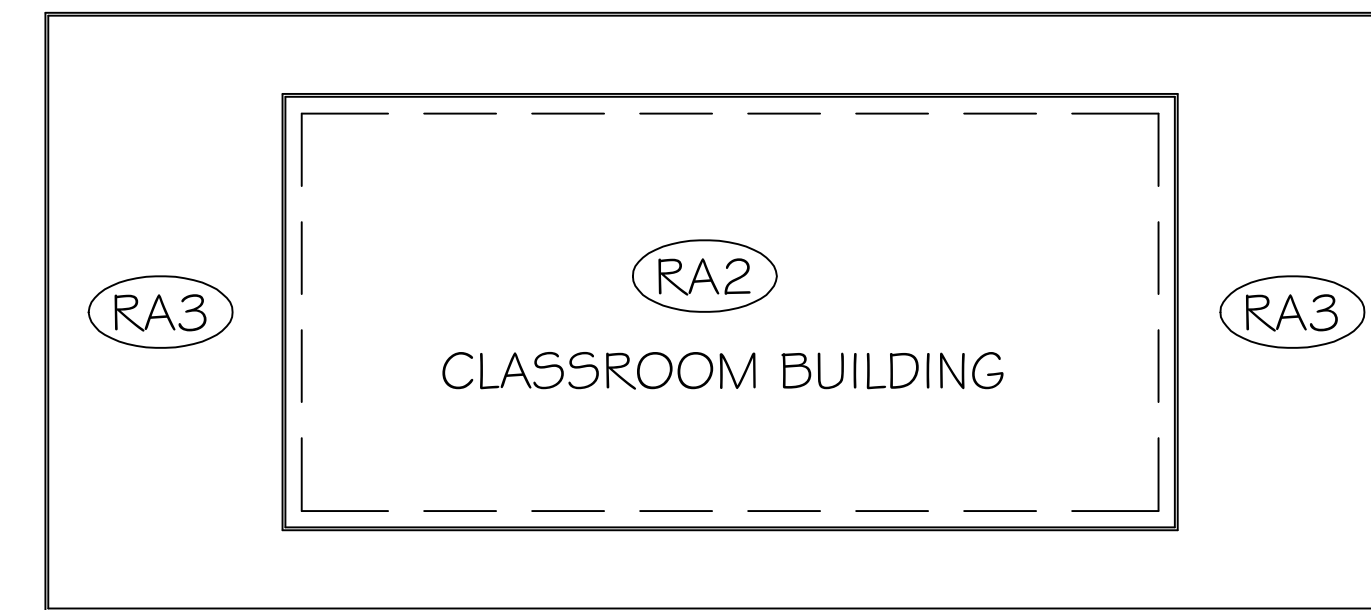

DRAWING INDEX	
SHEET	CONTENTS
K1	TITLE SHEET, SITE VICINITY MAP, KEY PLAN & DRAWING INDEX
R1	ROOF PLAN - OFFICE BUILDING
R2	ROOF PLAN - CLASSROOM BUILDING
D1	DETAILS
D2	DETAILS
D3	DETAILS

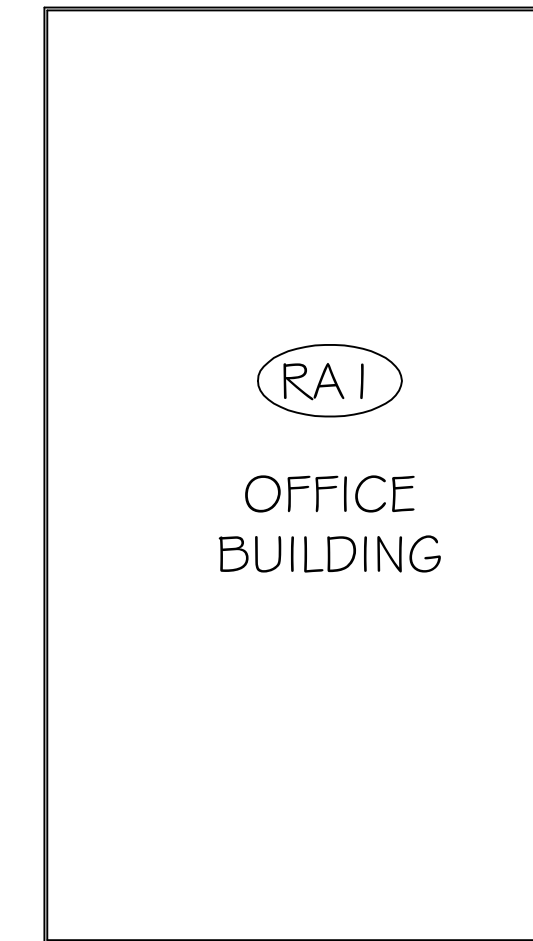
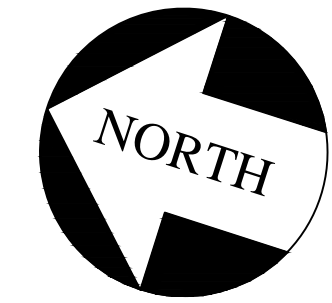
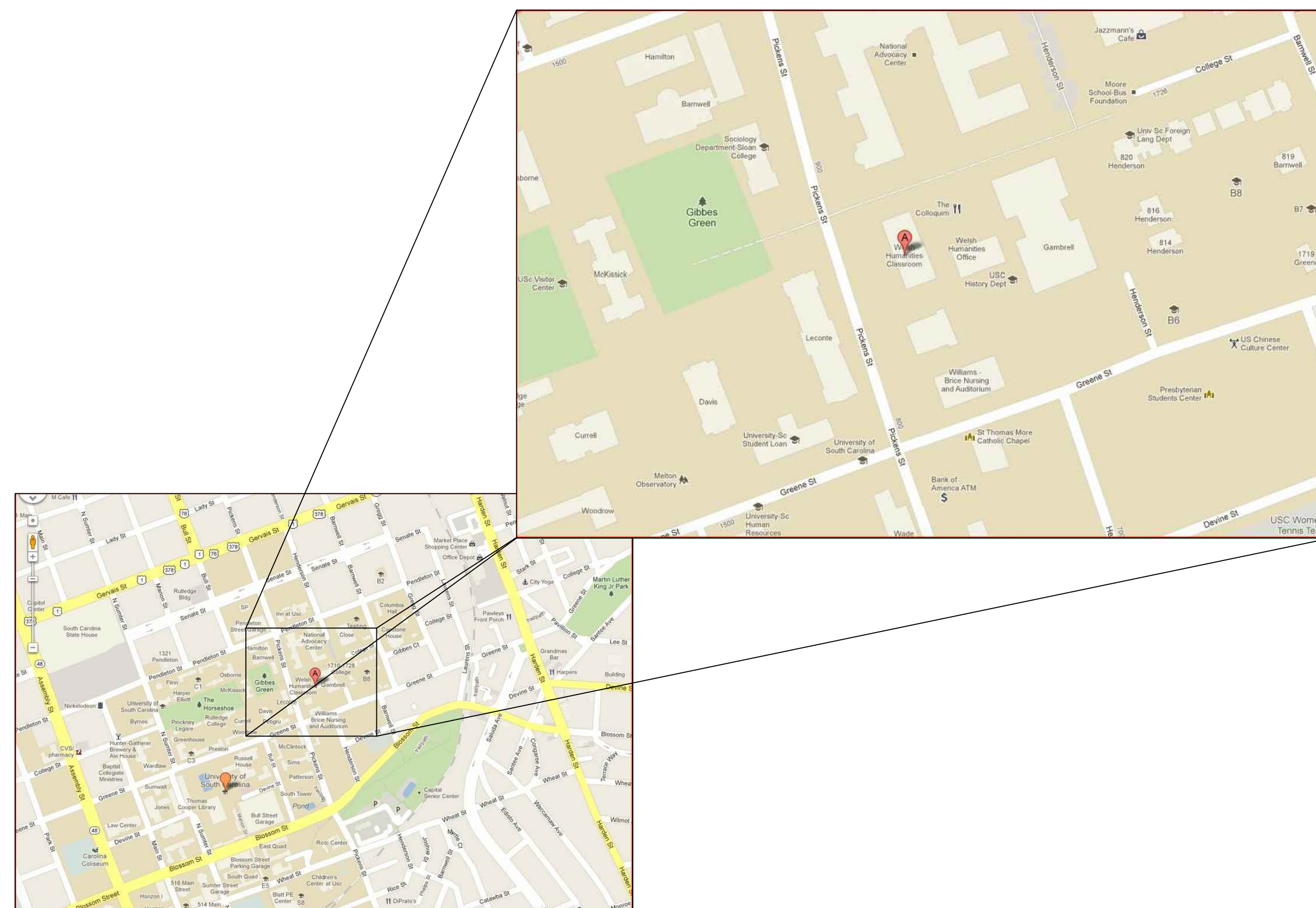

① SITE VICINITY MAP



② KEY PLAN

Shepard & Associates, LLC

3547 Dreher Shoals Road, Suite 6
Irmo, South Carolina 29063
Phone: (803) 407-8284
Fax: (803) 407-8206

SHEET TITLE: **Key Plan**
PROJECT DESCRIPTION: **Humanities Office & Classroom Buildings Reroofing Construction Project**
CLIENT NAME: **University of South Carolina - State Project Number - H27-6094**

REVISIONS	REVISION DATE	APPROVED

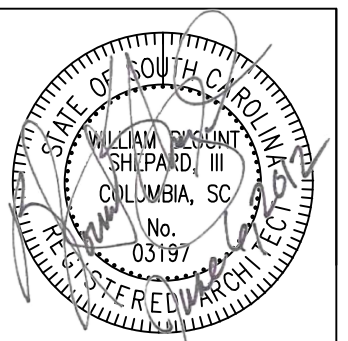
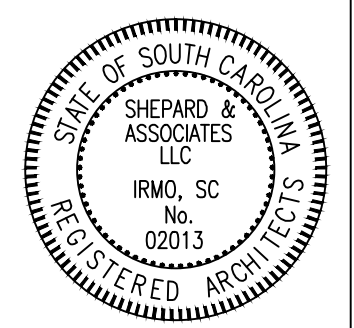

PF No. 11012.003.004
DATE: 4-26-12
SCALE: NTS
DRAWN BY: WMM
CHECKED BY: WBS

SHEET
K1

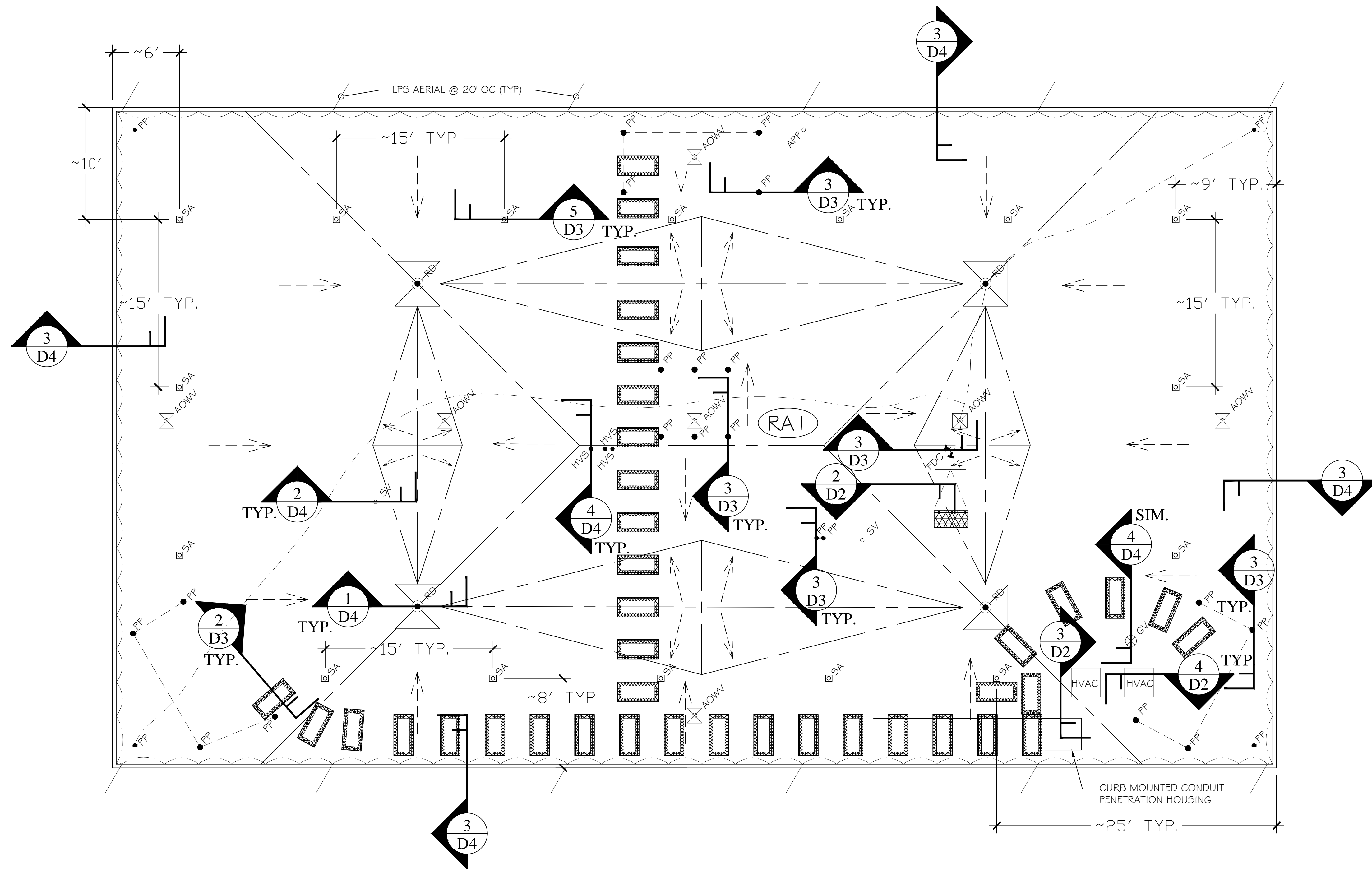
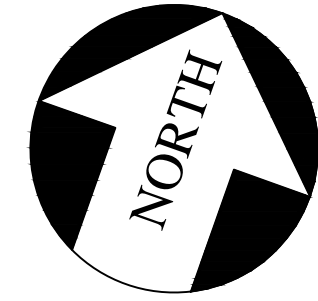

LEGEND

- RA # = ROOF AREA DESIGNATION
- = AREA IN CONTRACT
- = TAPERED INSULATION
- D = ROOF DRAIN # SUMP
- G = GRAVITY VENTILATOR
- = LIGHTNING PROTECTION
- SV = SANITARY VENT
- APP = ABANDONED PIPE PENETRATION
- HVS = HOT VENT STACK
- PP = PIPE PENETRATION
- RH = ROOF HATCH
- AOWV = ABANDON ONE WAY VENT
- FDC = FIRE DEPARTMENT CONNECTION
- HVAC = HVAC UNIT
- CCS = CONCRETE CONDUIT SUPPORT ON WALK PAD
- WP = WALK PAD
- = SLOPE IN INSULATION
- SA = SAFETY ANCHOR

1 ROOF PLAN - OFFICE BUILDING
 Note: New 3" Base Insulation with 1/4": 1 2" Taper

REVISIONS	DATE	APPROVED

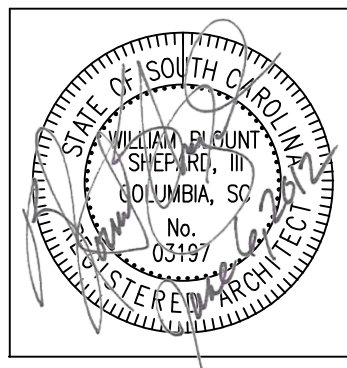
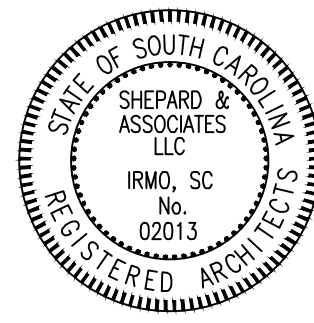

PF No. 11012.003.004
 DATE: 4-26-12
 SCALE: NTS
 DRAWN BY: WMM
 CHECKED BY: WBS

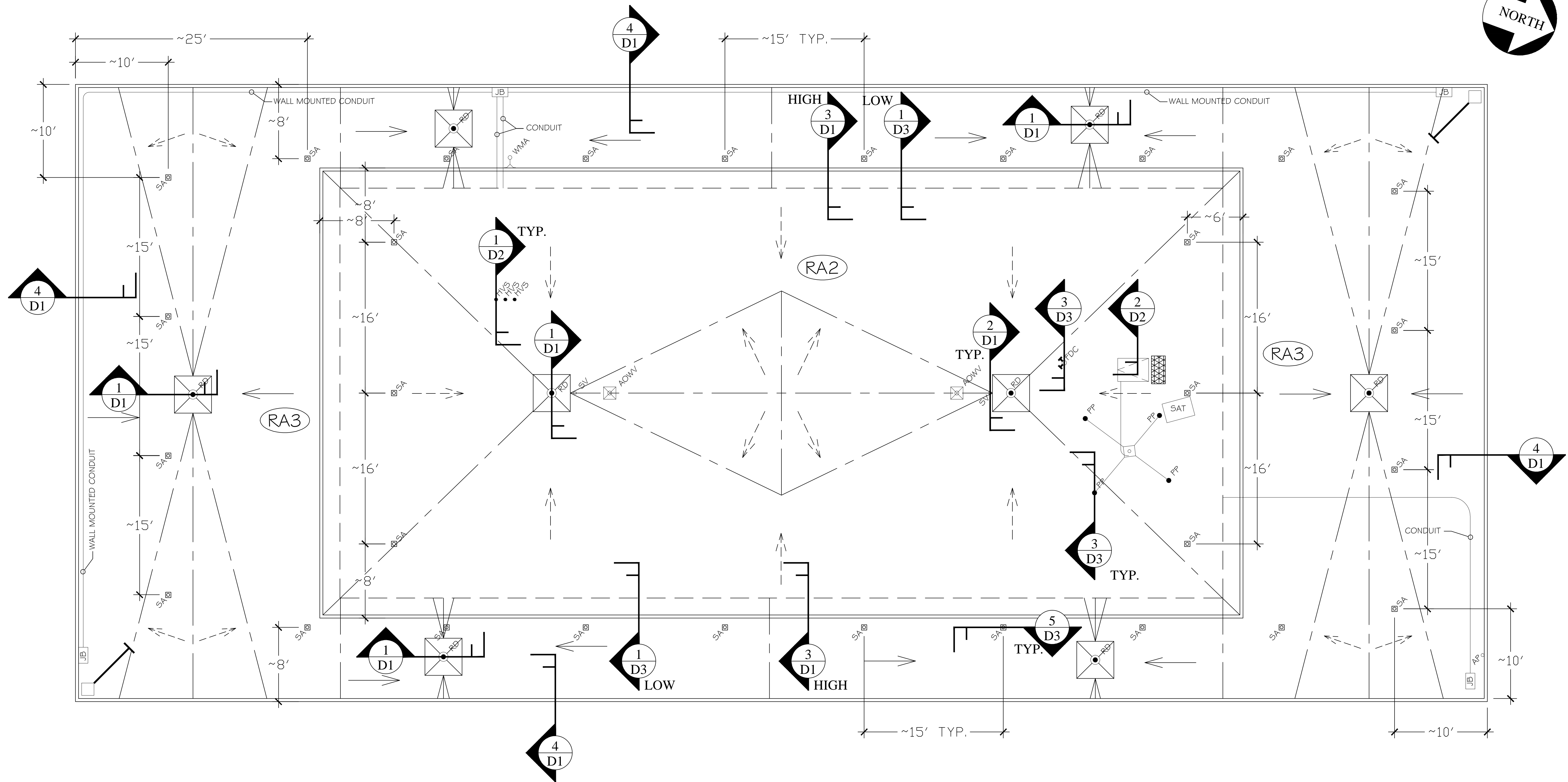

1 ROOF PLAN - CLASSROOM BUILDING
 Note: RA 2 - No Base Insulation w/ 1/8":1/2" Tapered Above LWC Deck.
 RA 3 1-1/2" Base Insulation w/ No Tapered Insulation.

LEGEND	
(RA #)	= ROOF AREA DESIGNATION
[]	= AREA IN CONTRACT
- - -	= TAPERED INSULATION
[RD]	= ROOF DRAIN
[JB]	= JUNCTION BOX
[SV]	= SANITARY VENT
[WMA]	= WALL MOUNTED ANTENNA
- - ->	= SLOPE IN INSULATION
->	= SLOPE IN ROOF DECK
[SA]	= NEW SAFETY ANCHOR
[HVS]	= HOT VENT STACK
[PP]	= PIPE PENETRATION
[RH]	= ROOF HATCH
[SAT]	= SATELLITE TV DISH
[AWMP]	= ABANDON WALL MOUNTED PIPE
[AOWV]	= ABANDON ONE WAY VENT
[FDC]	= FIRE DEPARTMENT CONNECTION
[BPA]	= BALLASTED P.A. SYSTEM SPEAKERS
[WP]	= WALK PAD

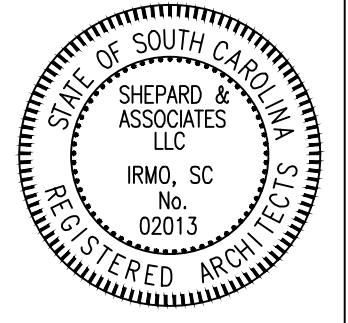

Shepard & Associates, LLC
 3547 Dreher Shoals Road, Suite 6
 Irmo, South Carolina 29063
 Phone: (803) 407-8284
 Fax: (803) 407-8206

Roof Plan
 PROJECT DESCRIPTION:
 Humanities Office & Classroom Buildings Reroofing Construction Project
 CLIENT NAME:
 University of South Carolina - State Project Number - H27-6094

REVISIONS	REVISION	DATE	APPROVED

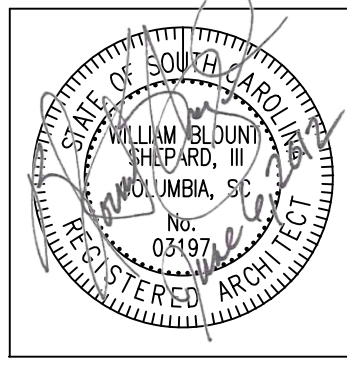

PF No. 11012.003.004
 DATE: 4-26-12
 SCALE: NTS
 DRAWN BY: WMM
 CHECKED BY: WBS

SHEET
R2

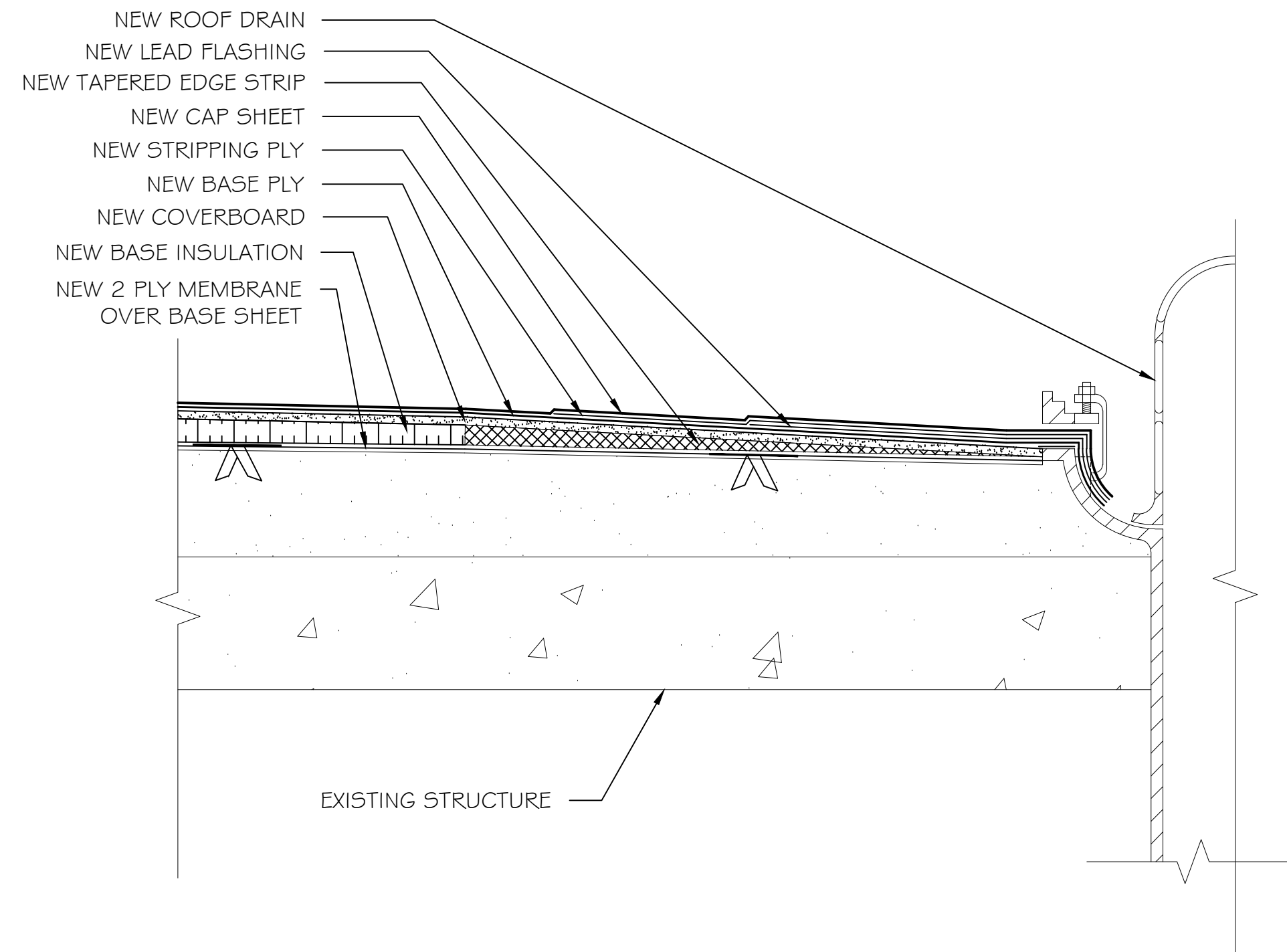

1 TYPICAL ROOF DRAIN DETAIL

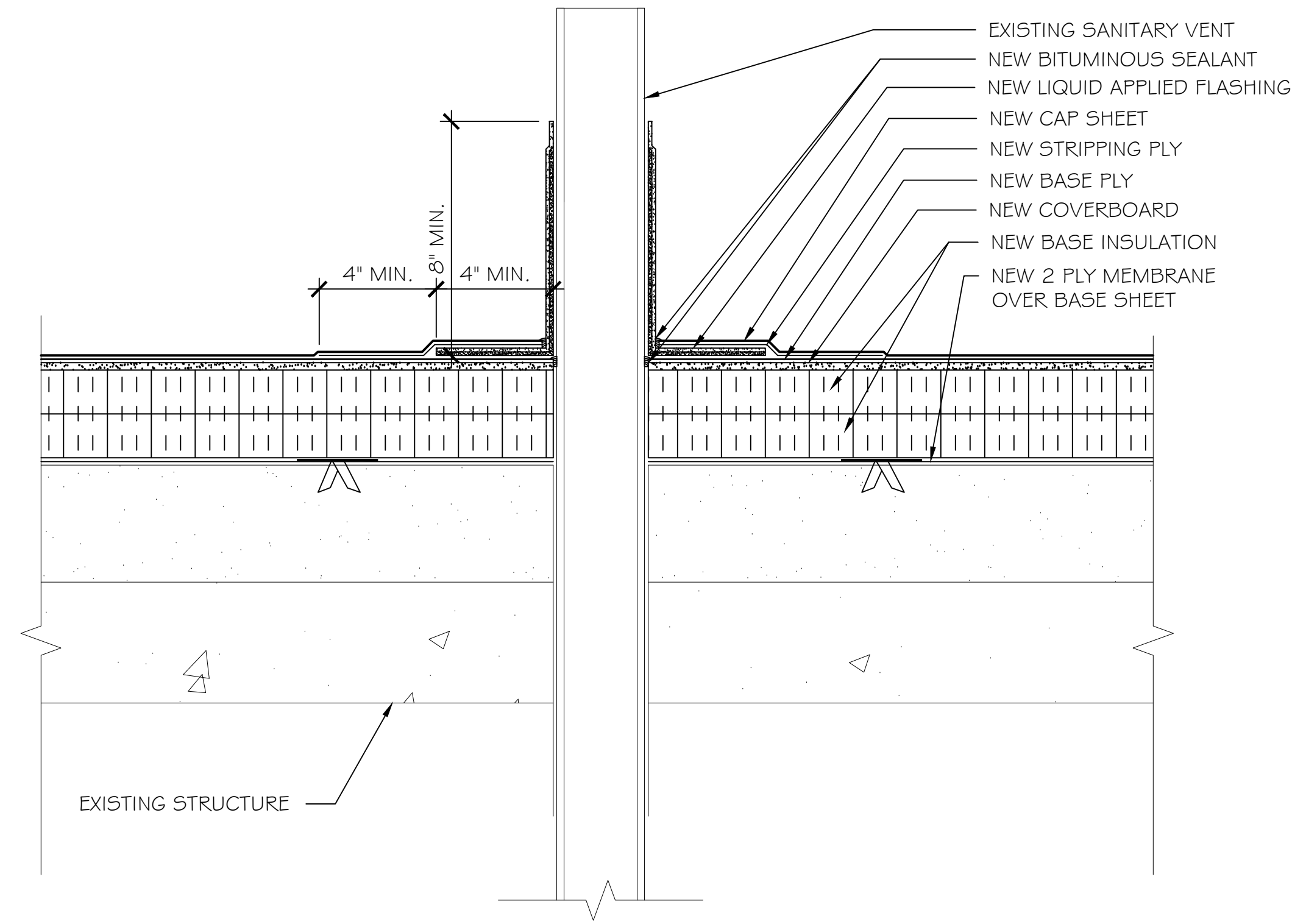

2 TYPICAL SANITARY VENT DETAIL

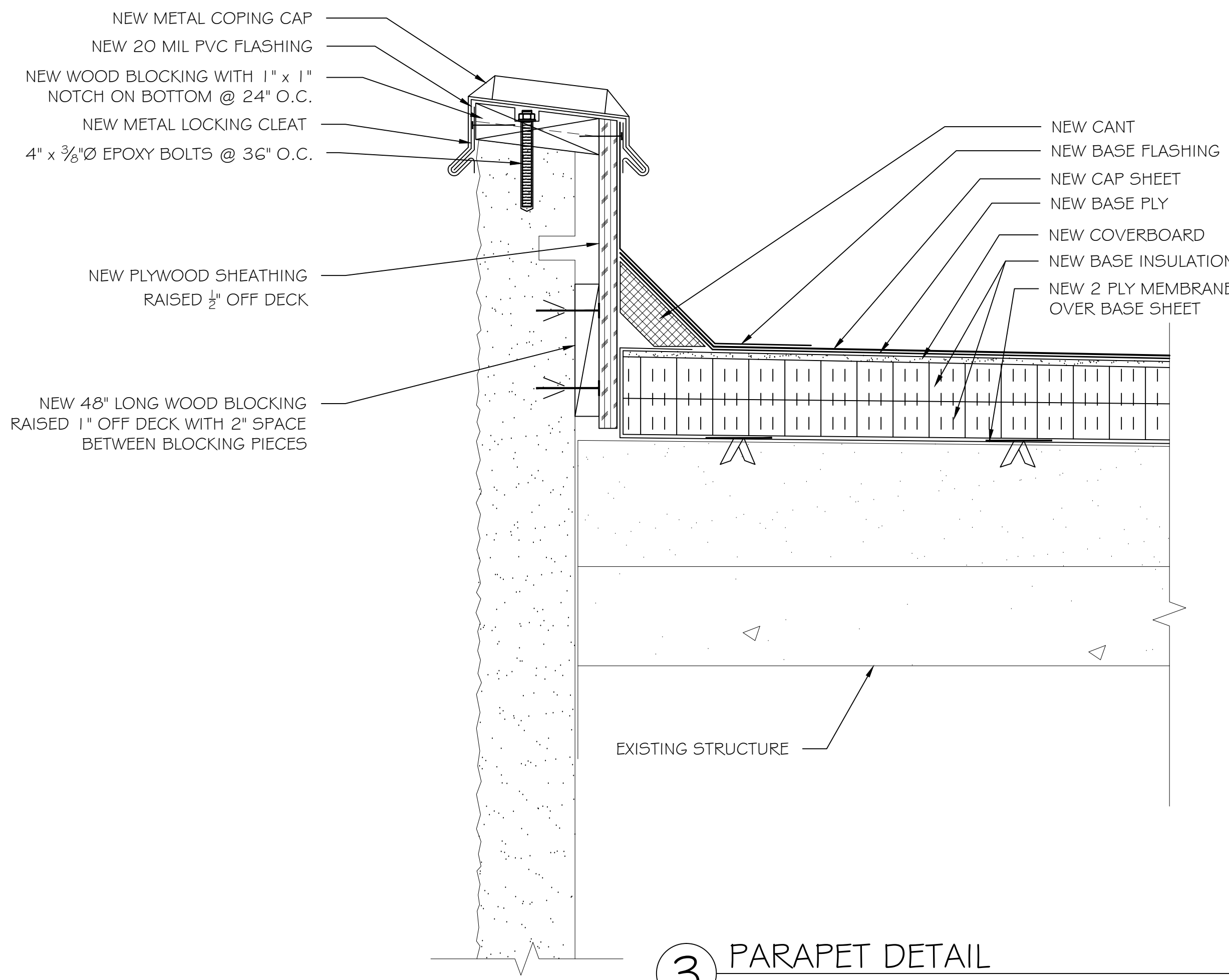

3 PARAPET DETAIL

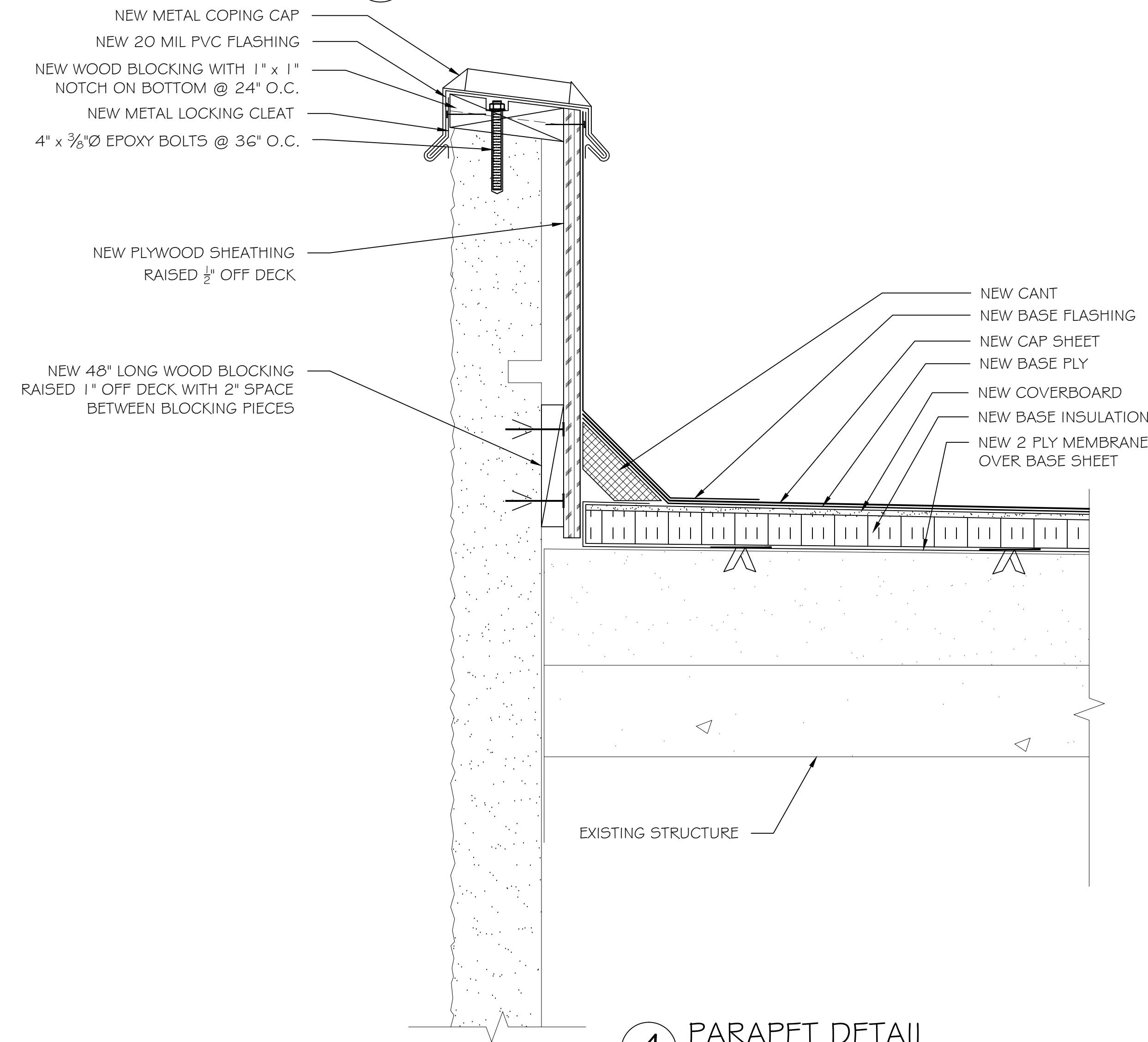

4 PARAPET DETAIL

REVISIONS	REVISION	DATE	APPROVED

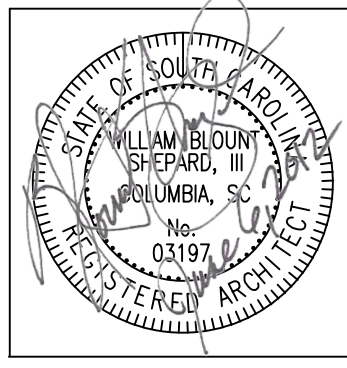
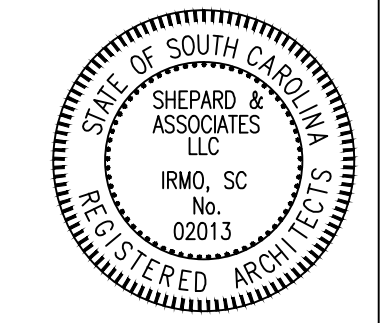

PF No. 11012.003.004
 DATE: 4-26-12
 SCALE: NTS
 DRAWN BY: WMM
 CHECKED BY: WBS

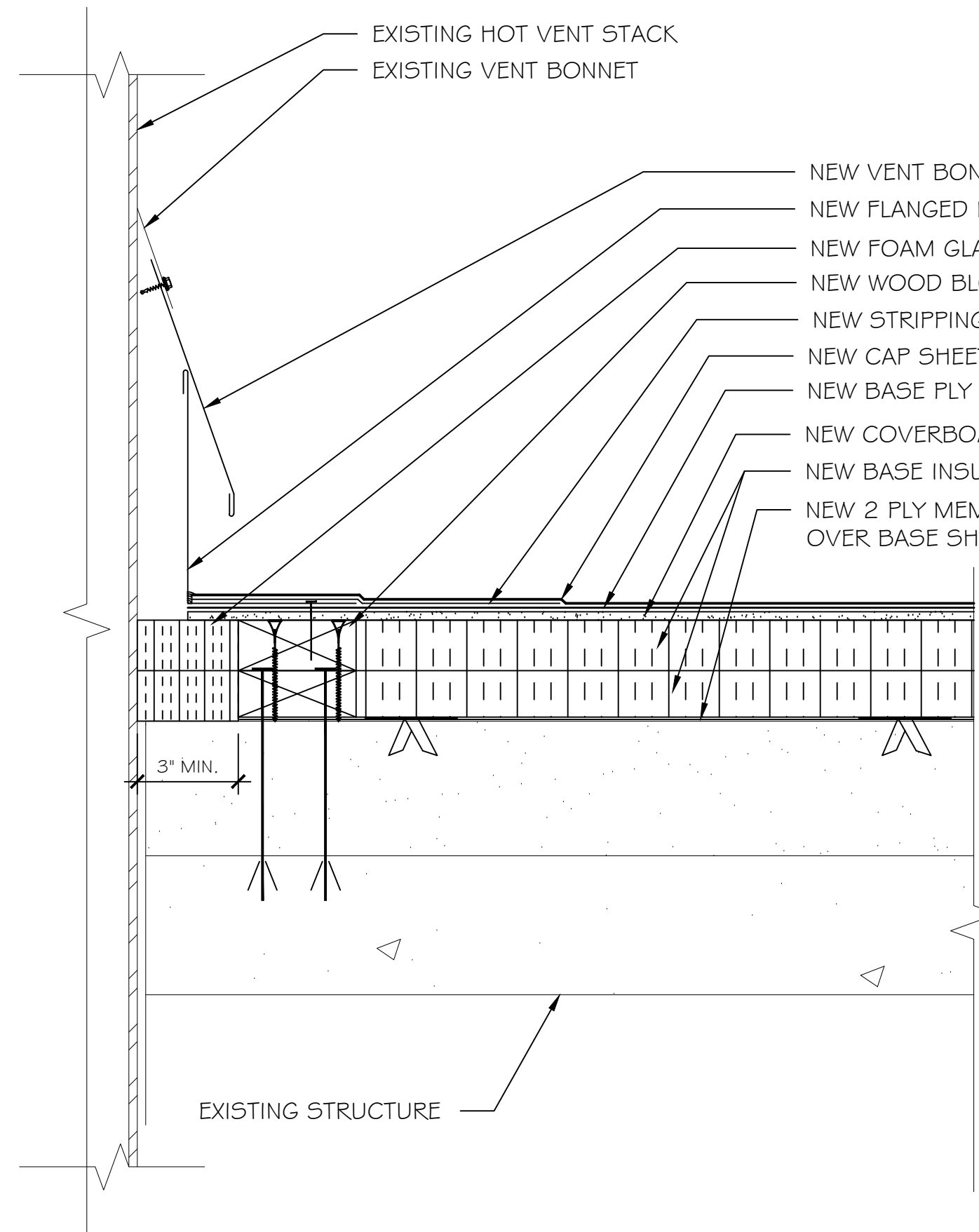

1 TYPICAL HOT VENT STACK DETAIL

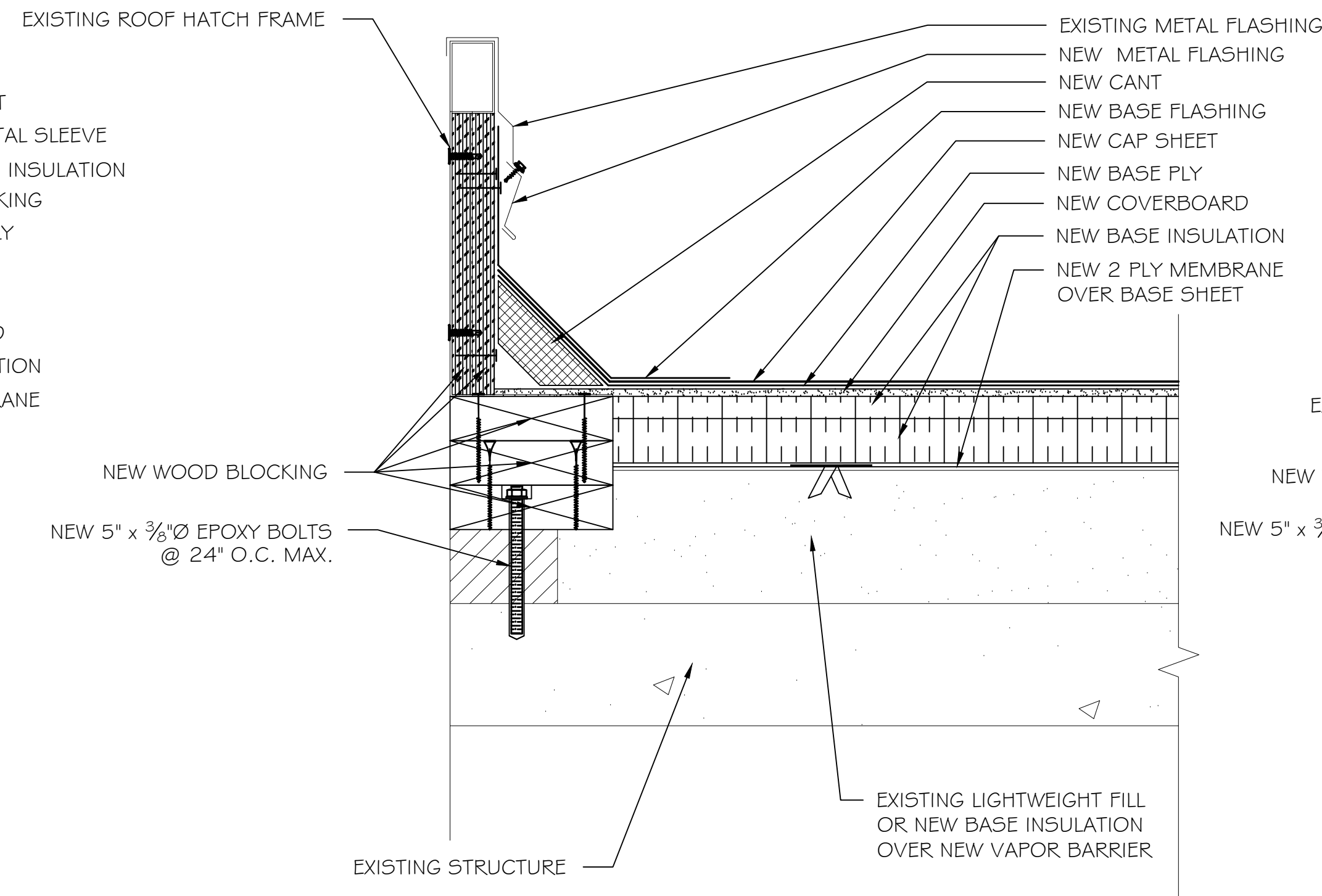

2 EXISTING ROOF HATCH DETAIL

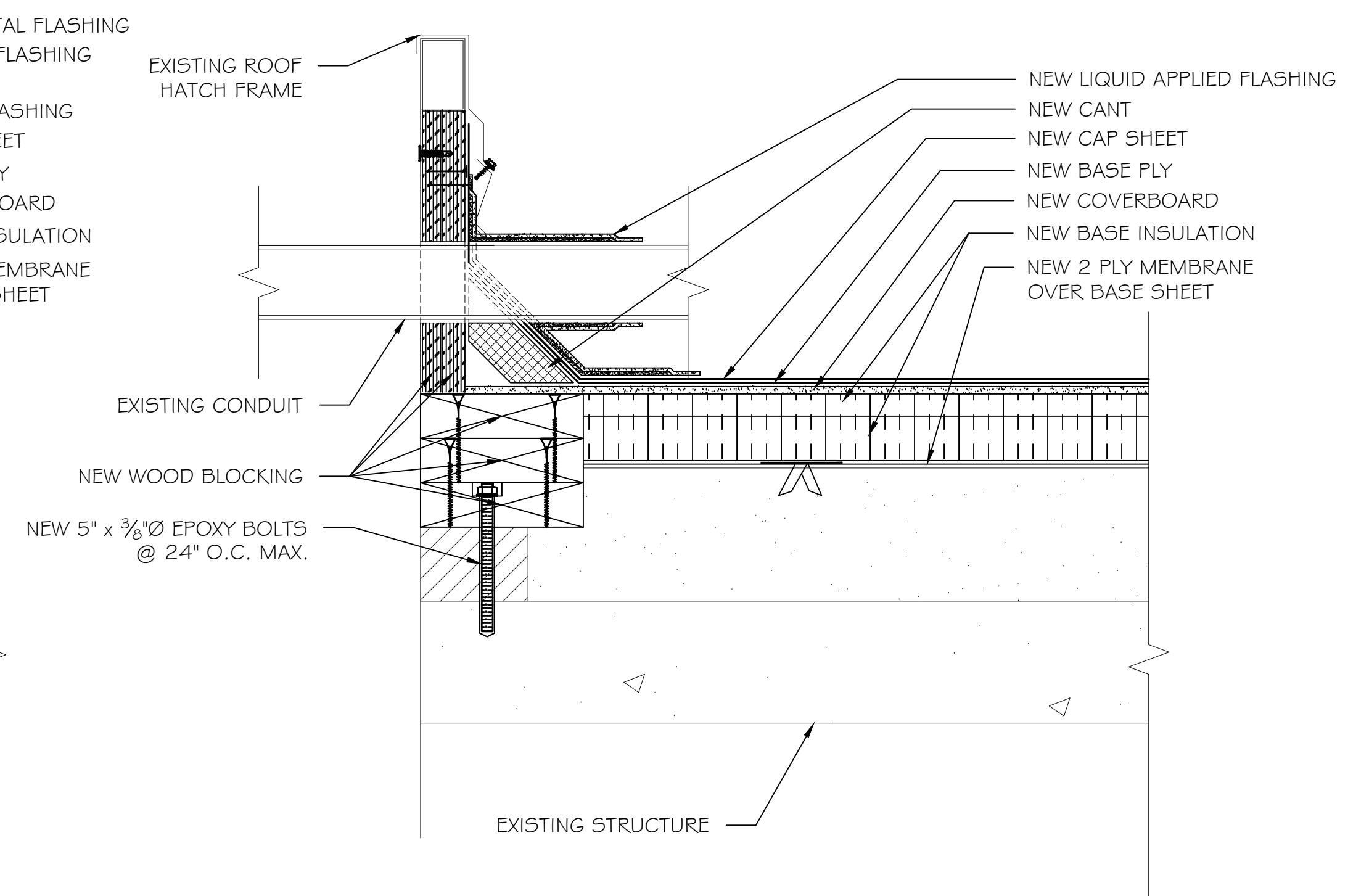

2A EXISTING ROOF HATCH DETAIL @ CONDUIT PENETRATION
USE THIS SECTION ON SIDE WHERE CONDUIT PENETRATES ROOF HATCH FRAME ONLY

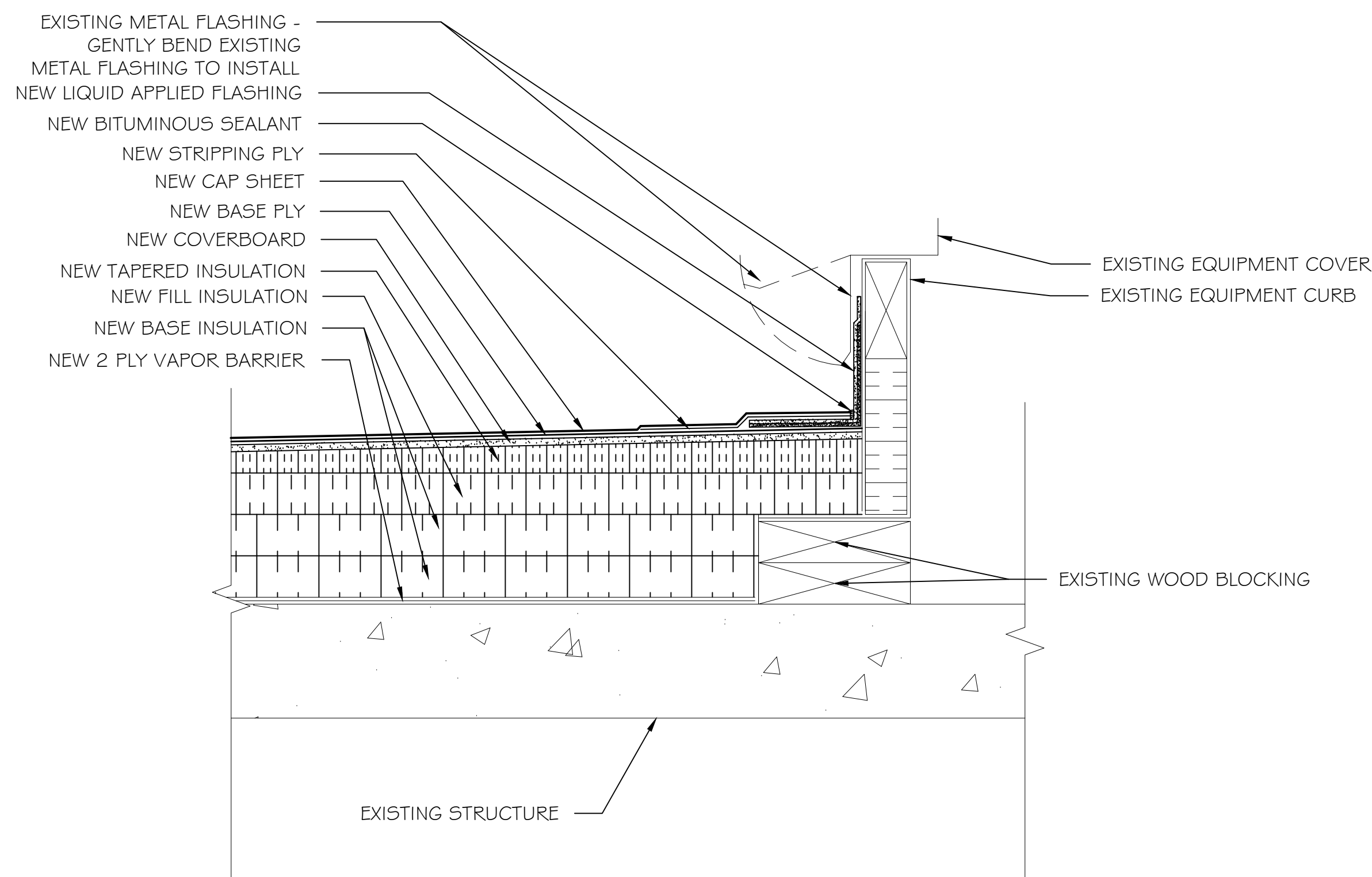

3 TELEPHONE CONDUIT PENETRATION HOUSING CURB

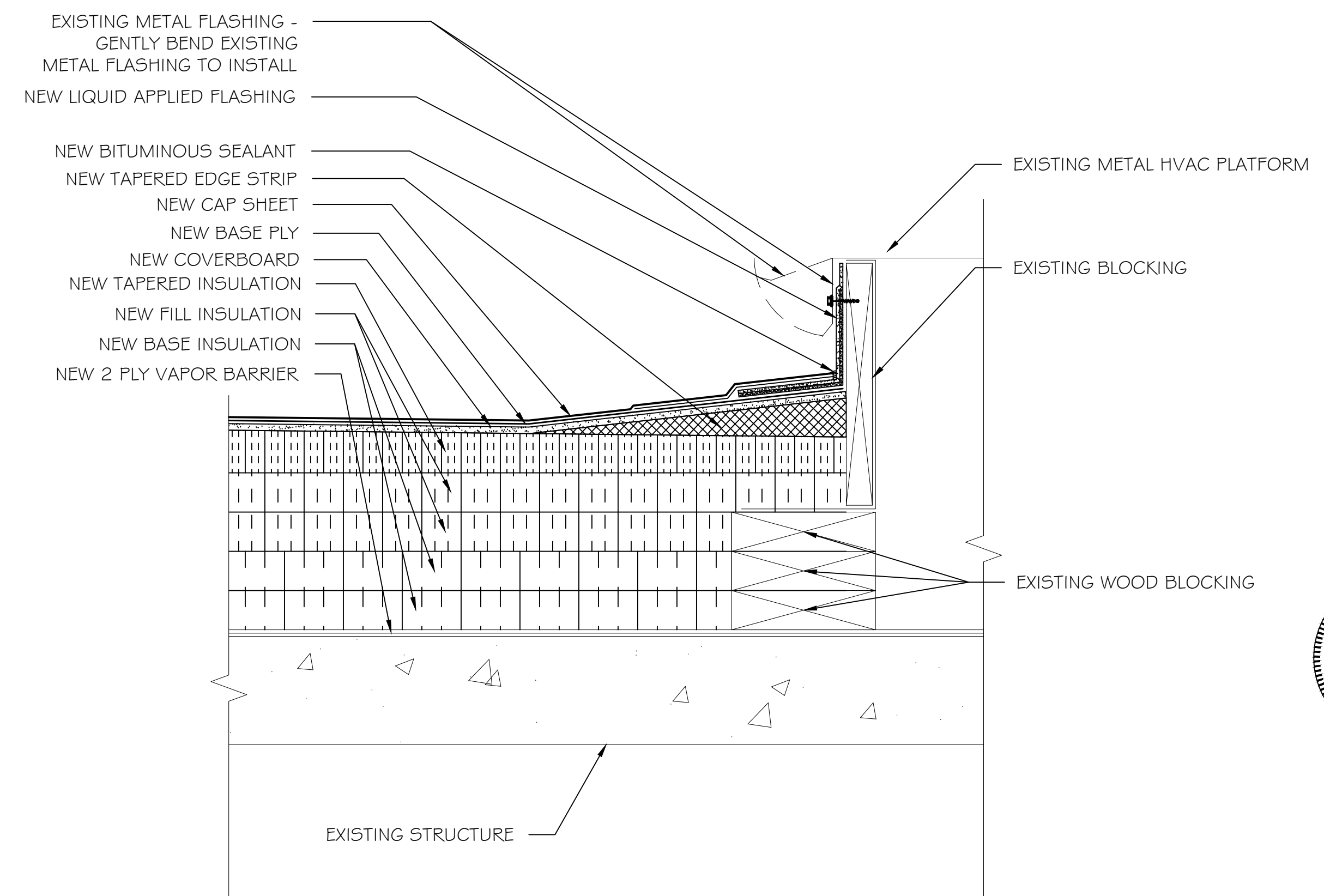

4 EXISTING HVAC PLATFORM CURB

REVISIONS	REVISION	DATE	APPROVED

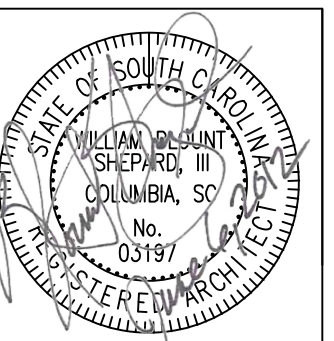
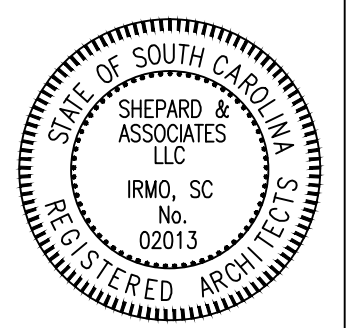

PF No. 11012.003.004
DATE: 4-26-12
SCALE: NTS
DRAWN BY: WMM
CHECKED BY: WBS

SHEET TITLE:

REVISIONS	REVISION	DATE	APPROVED

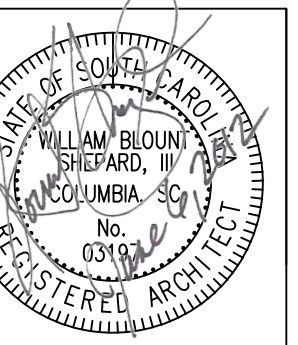

PF No. 11012.003.004
 DATE: 4-26-12
 SCALE: NTS
 DRAWN BY: WMM
 CHECKED BY: WBS

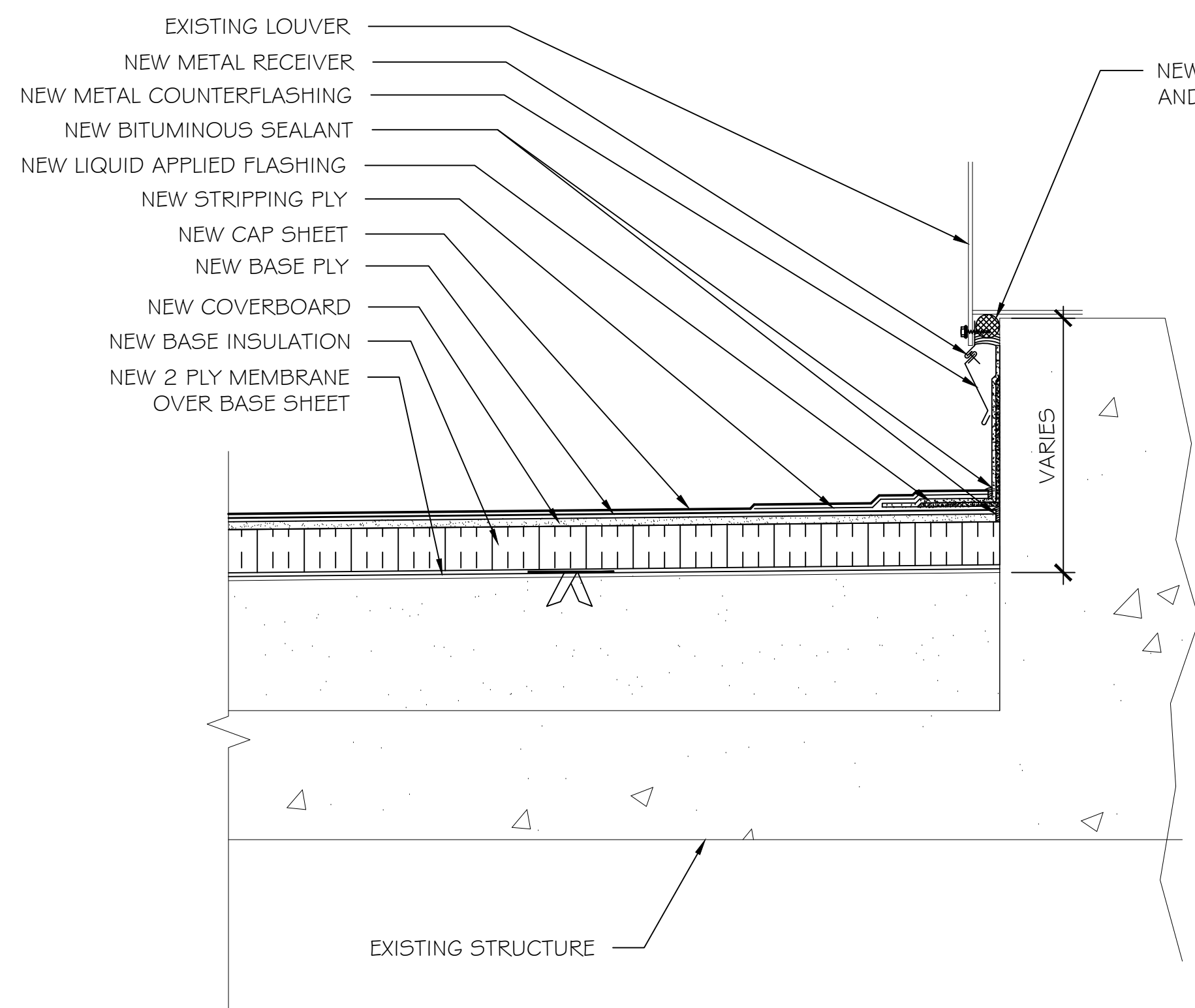

1 TYPICAL DETAIL AT LOUVER

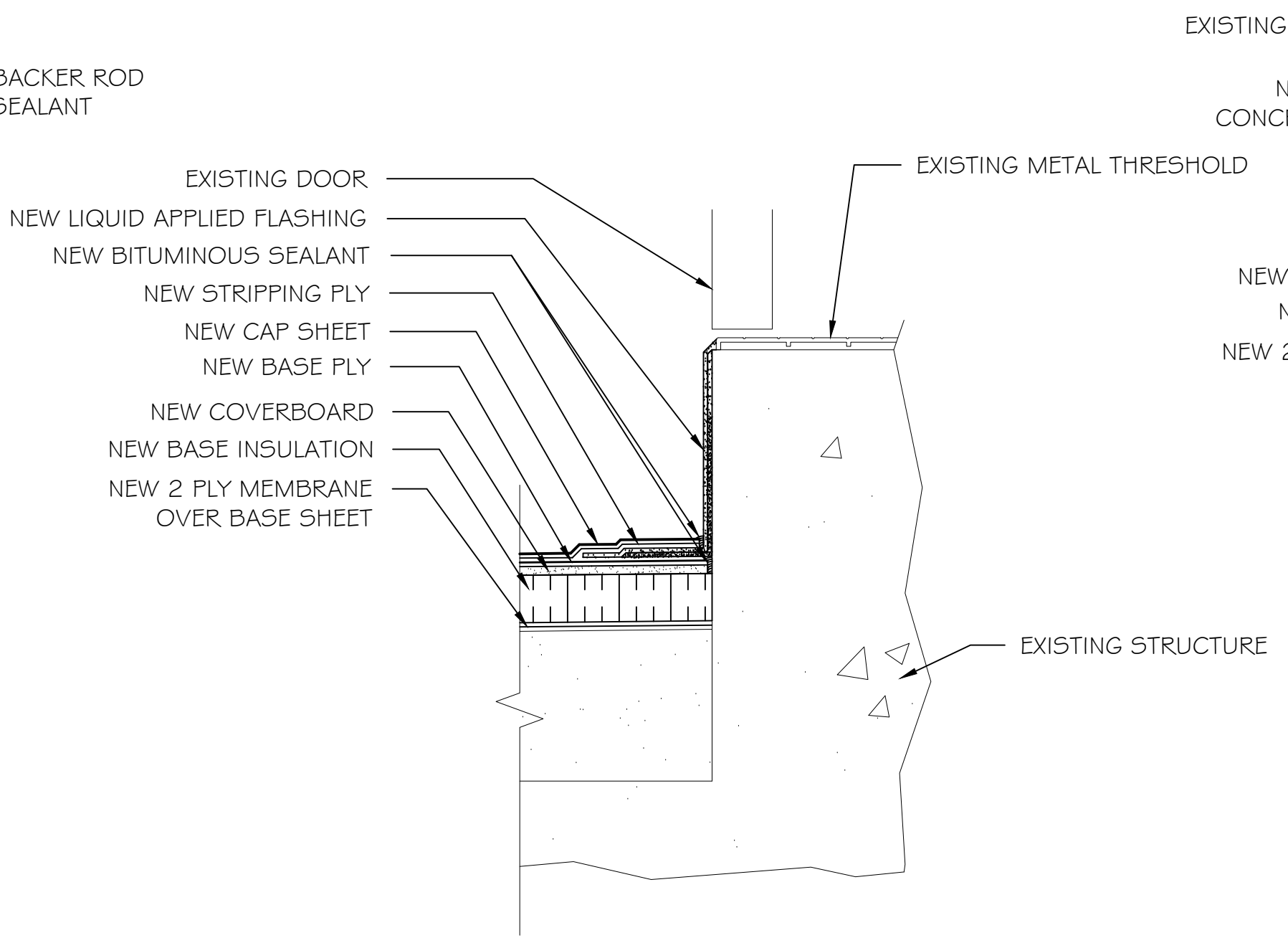

1A TYPICAL DETAIL AT LOUVER
 USE THIS SECTION AT LOUVER WALL WHERE DOOR IS LOCATED

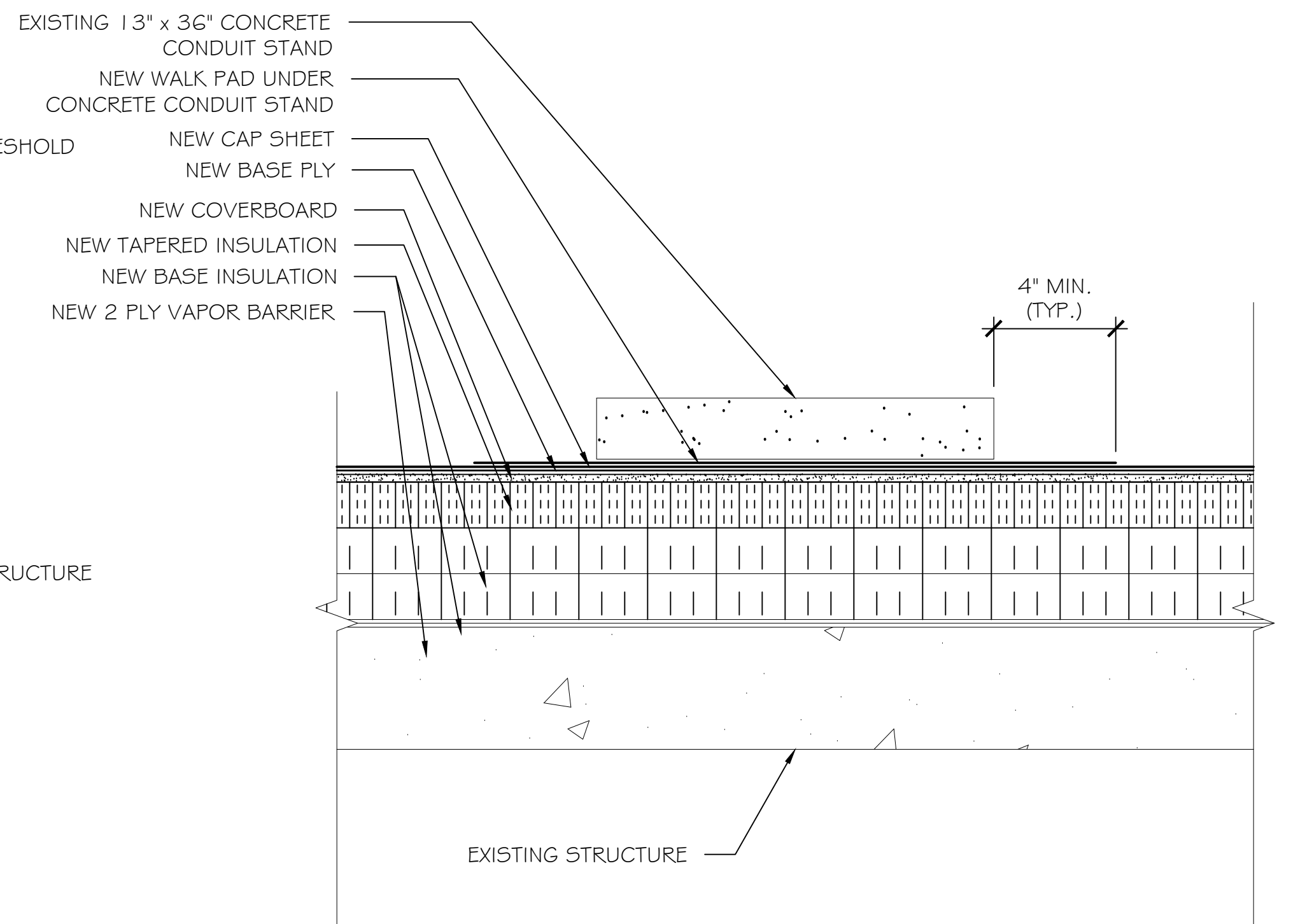

2 TYPICAL DETAIL AT CONCRETE CONDUIT STAND

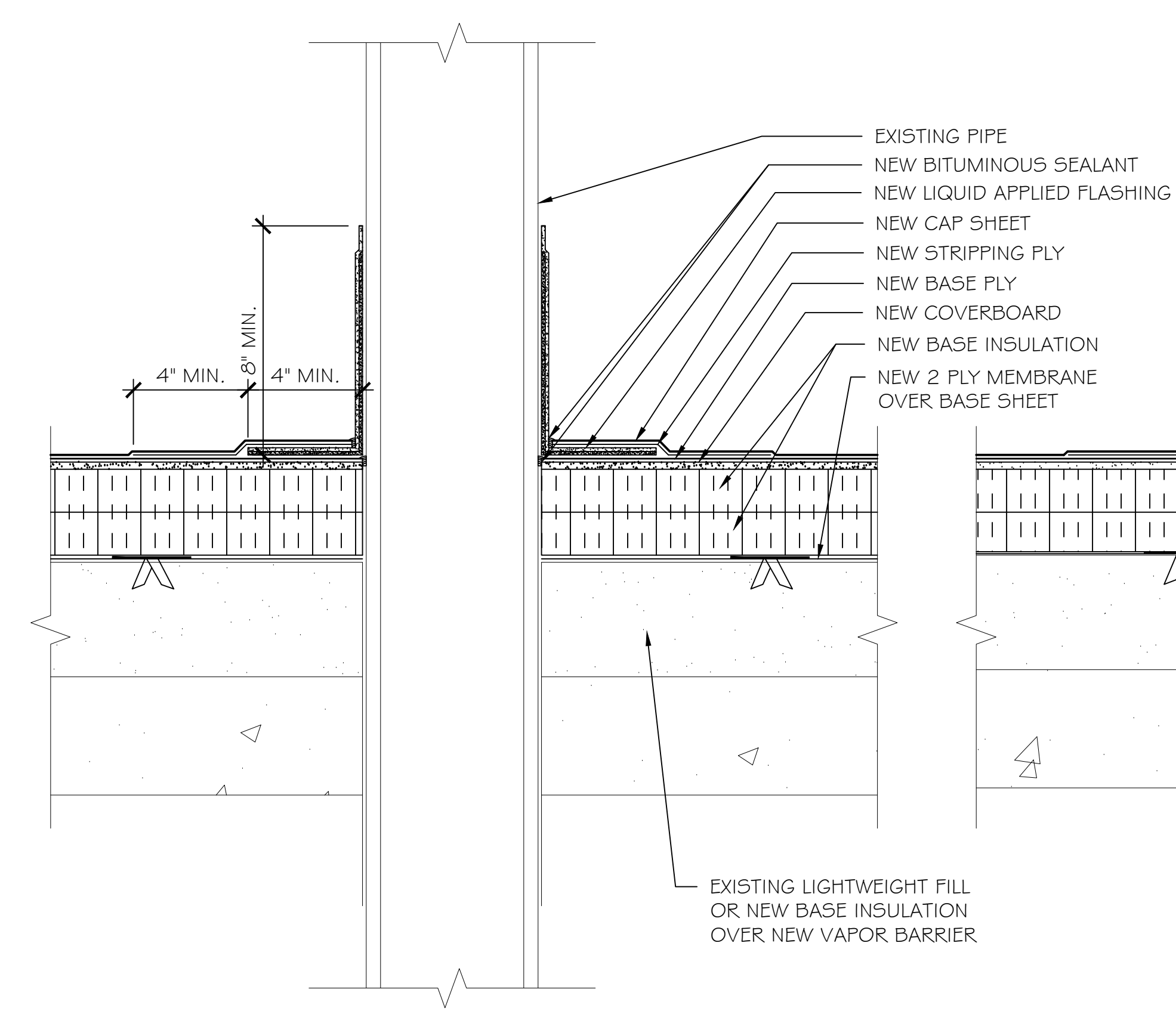

3 TYPICAL PIPE PENETRATION DETAIL

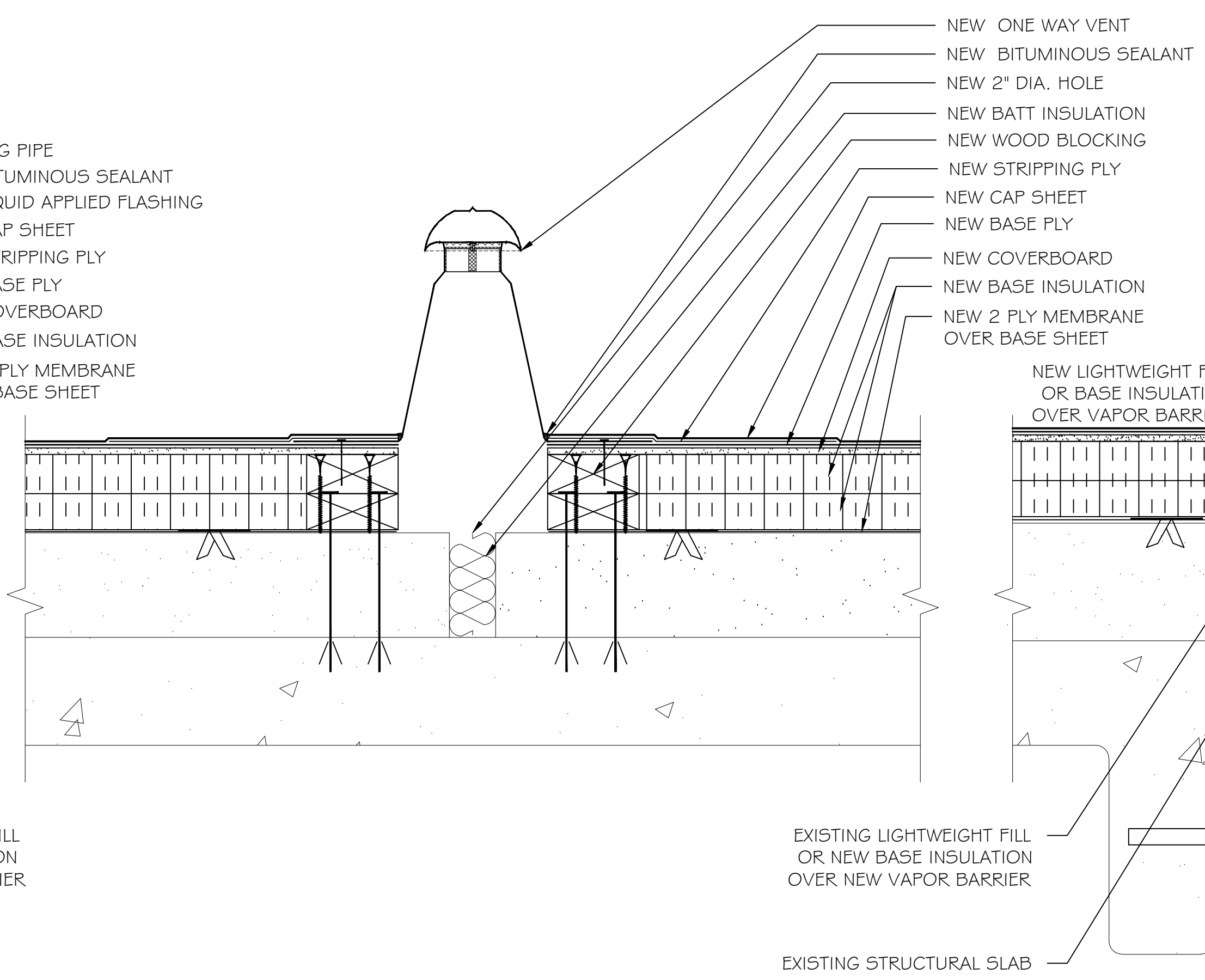

4 NEW ONE WAY VENT DETAIL

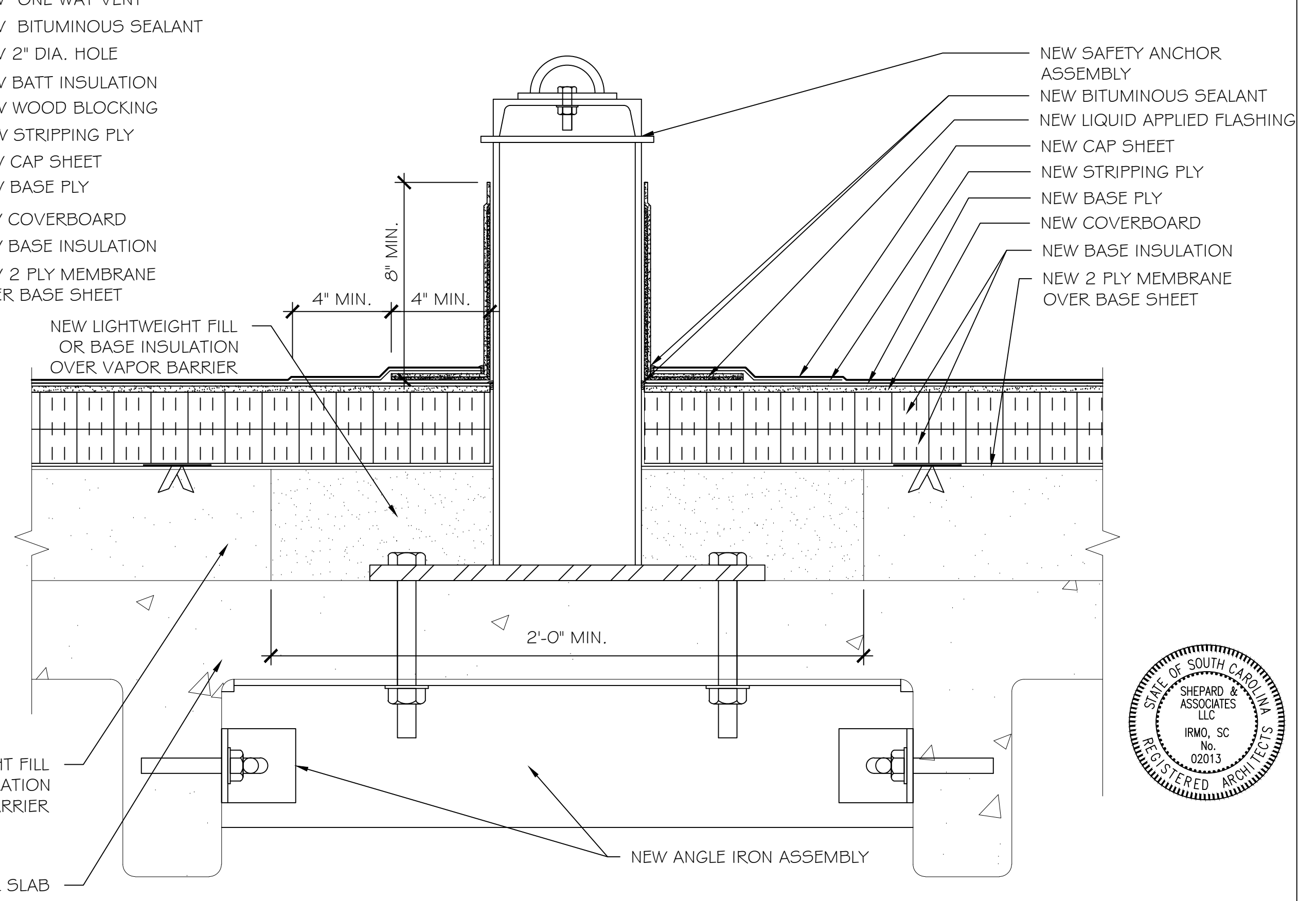

5 SAFETY ANCHOR BASE DETAIL

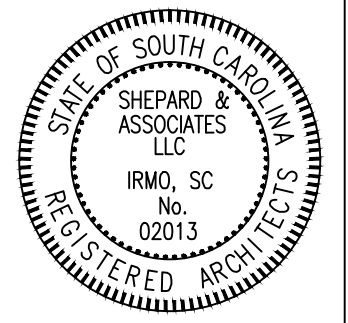

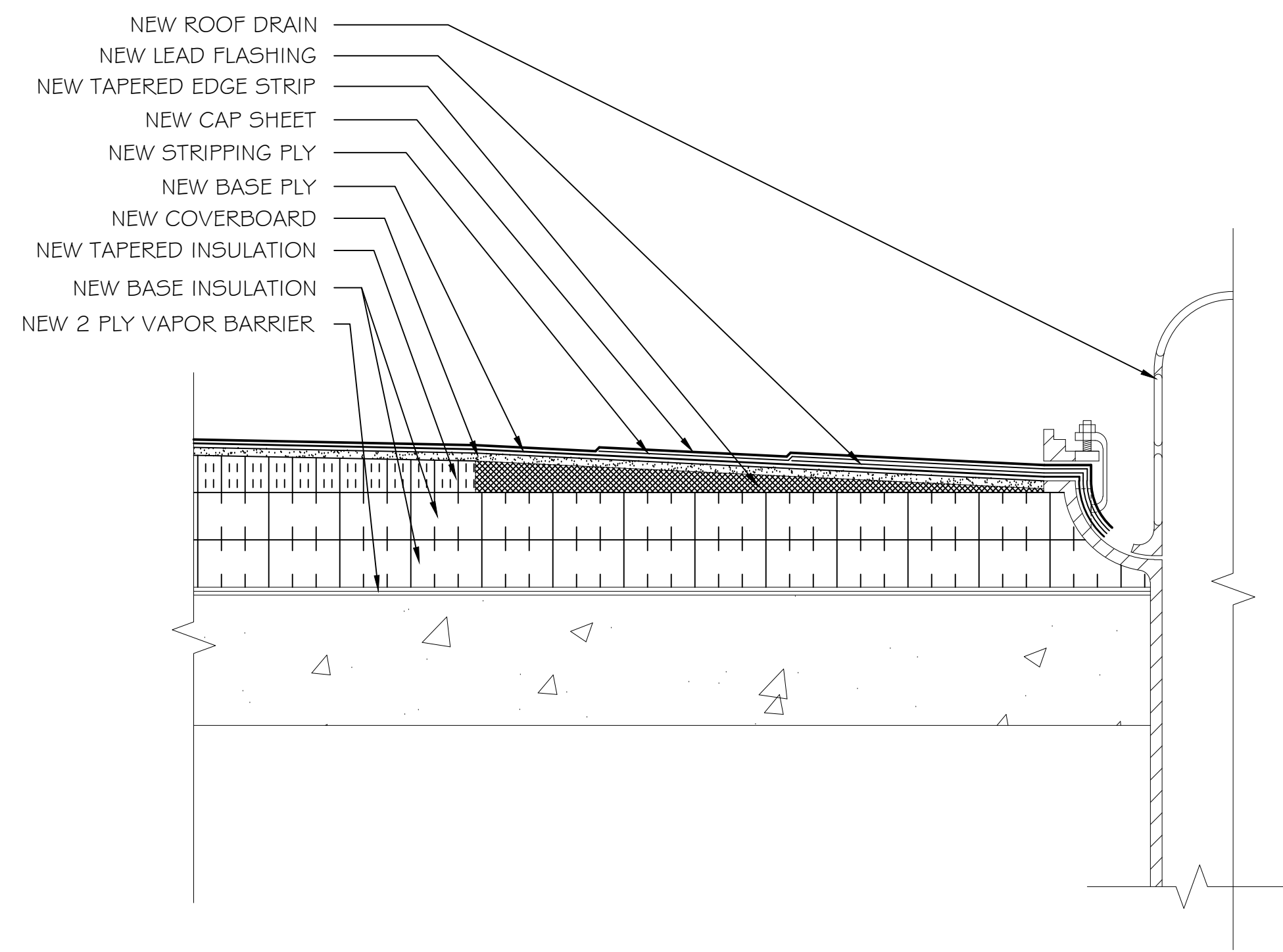

1 TYPICAL ROOF DRAIN DETAIL

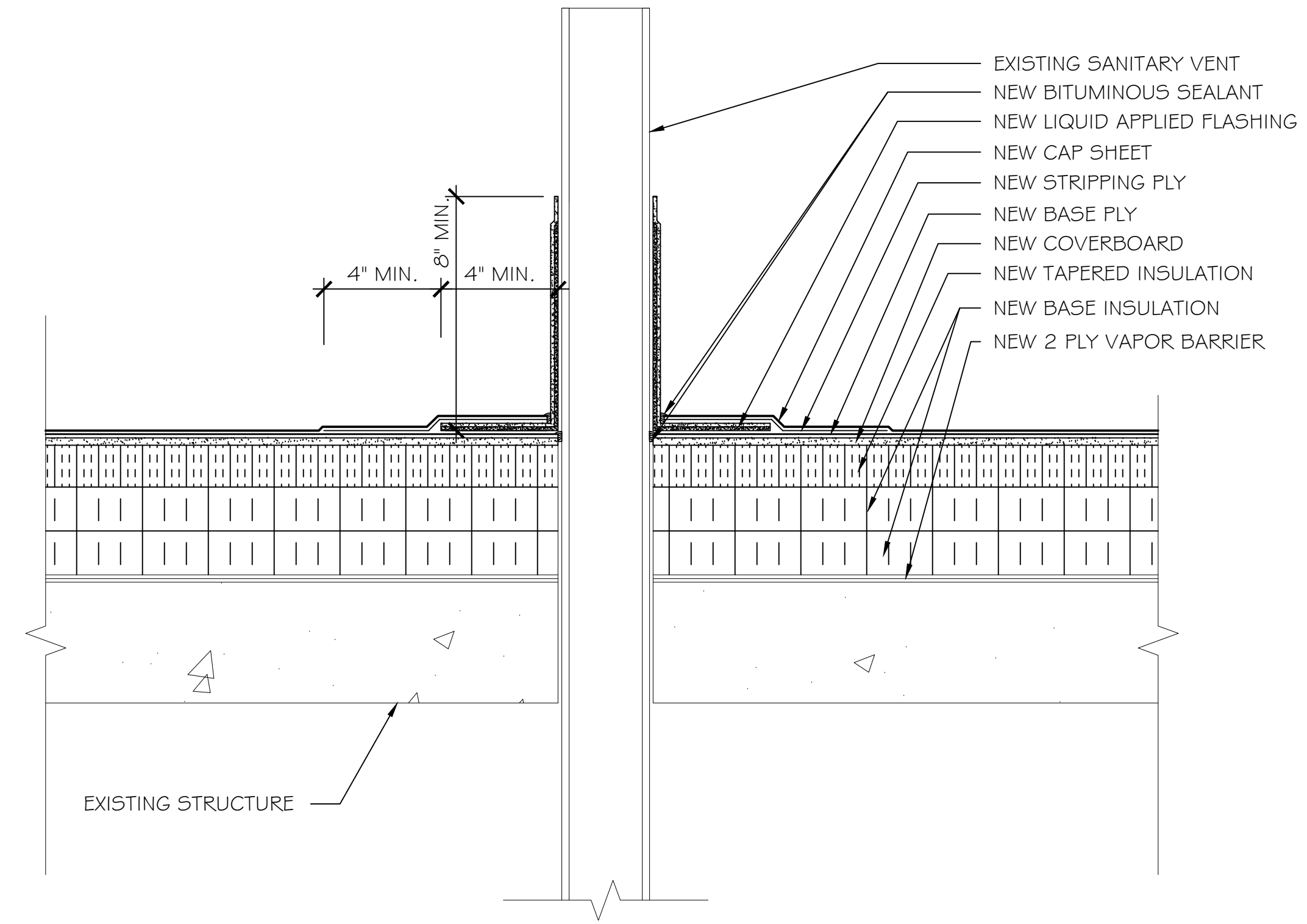

2 TYPICAL SANITARY VENT DETAIL

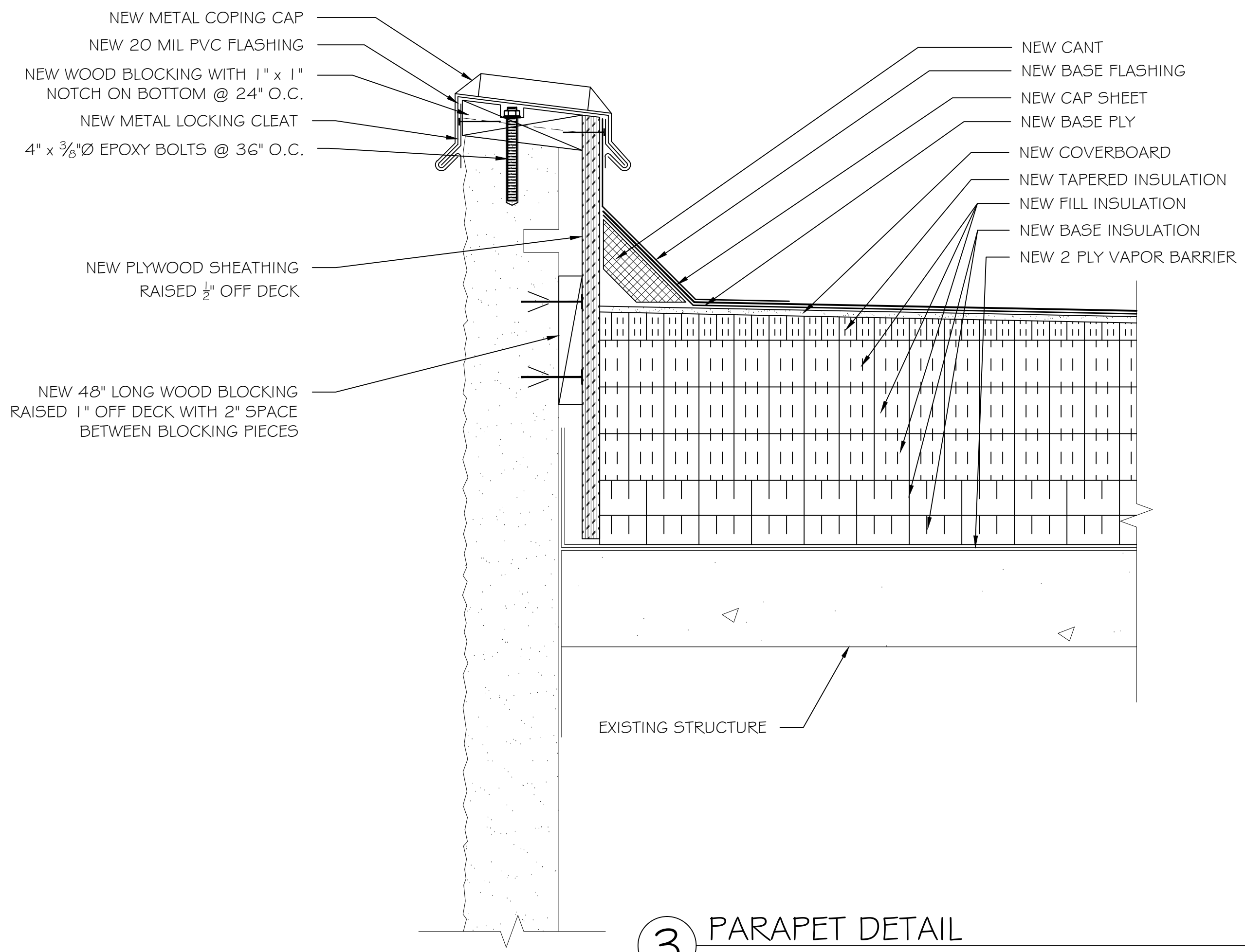

3 PARAPET DETAIL

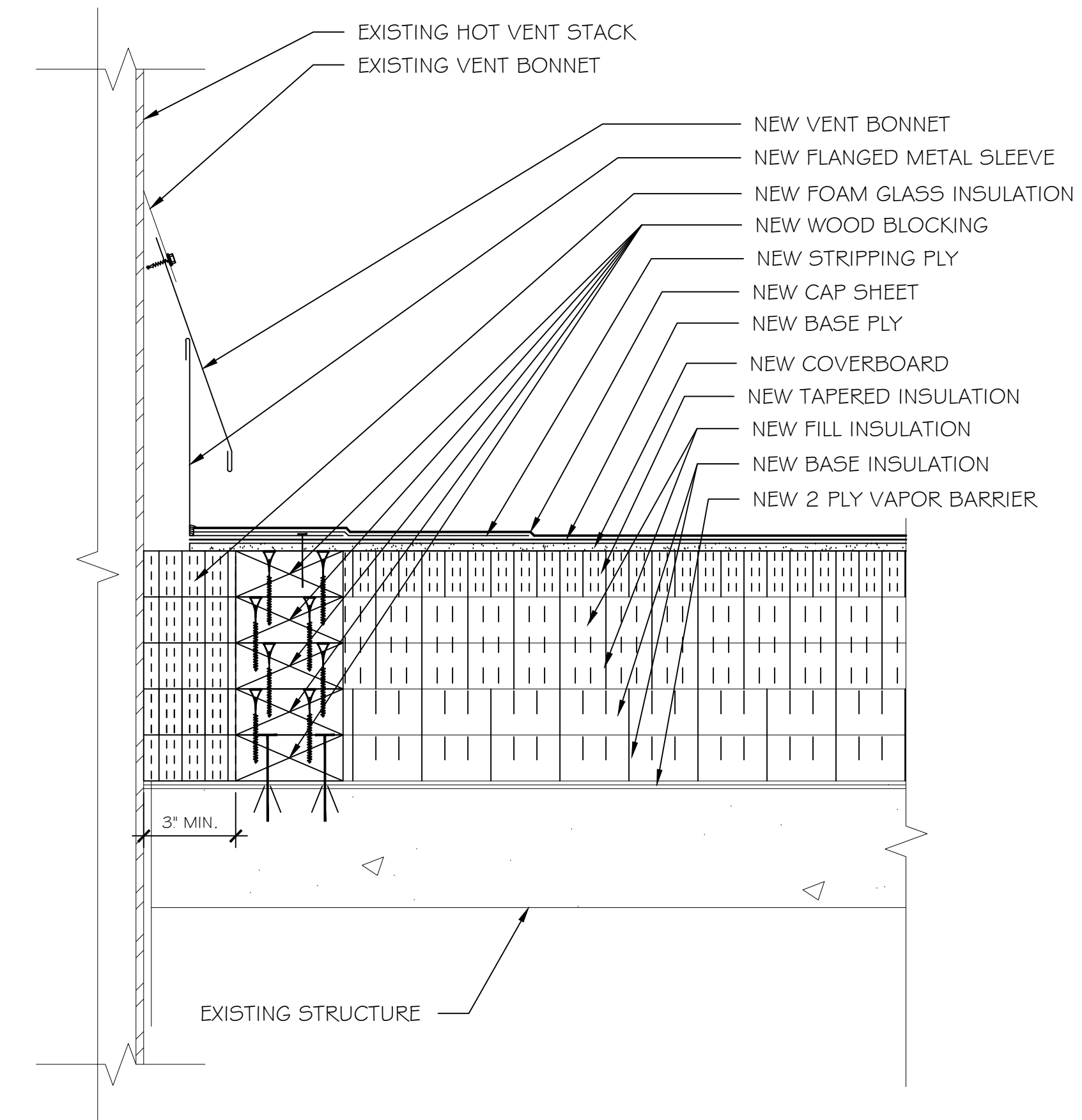

4 TYPICAL HOT VENT STACK DETAIL

REVISIONS	REVISION	DATE	APPROVED

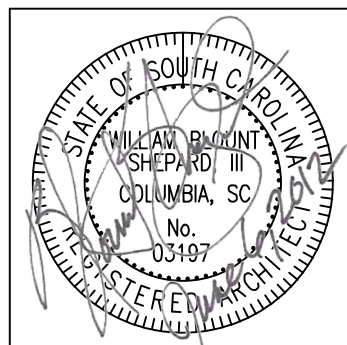
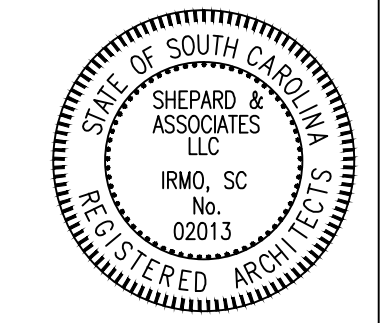

PF No. 11012.003.004
 DATE: 4-26-12
 SCALE: NTS
 DRAWN BY: WMM
 CHECKED BY: WBS